

Section 4

Rotameters



Rotameters

Page



Rotameters

4.4



Rotameter Component Parts

4.11

Rotameter Ordering Information

4.21

Rotameters

Rotameters

Type 807 Rotameter - Polyamide Complete Assembly PVC Socket Ends, EPDM Seals, Standard Tube

C



Size [inch]	Standard Float Part No.	USD	Magnetic Float Part No.	USD	SK	Flow Range [gal/min]
1	198 807 622 ^	133.00	198 807 630 ^	183.00	10	0.22-2.20
1	198 807 623 ^	133.00	198 807 631 ^	183.00	11	0.44-4.40
1 ½	198 807 624 ^	185.00	198 807 632 ^	263.00	20	1.30-13.0
1 ½	198 807 625 ^	185.00	198 807 633 ^	263.00	21	2.60-26.0
2	198 807 626 ^	285.00	198 807 634 ^	408.00	30	4.40-44.0
2	198 807 627 ^	285.00	198 807 635 ^	408.00	31	6.60-66.0
2 ½	198 807 628 ^	464.00	198 807 636 ^	667.00	40	8.80-88.0
2 ½	198 807 629 ^	464.00	198 807 637 ^	667.00	41	13.2-132.0

Type 807 Rotameter - Polyamide Complete Assembly PVC Socket Ends, FPM Seals, Standard Tube

C



Size [inch]	Standard Float Part No.	USD	Magnetic Float Part No.	USD	SK	Flow Range [gal/min]
1	198 807 638 ^	138.00	198 807 646 ^	187.00	10	0.22-2.20
1	198 807 639 ^	138.00	198 807 647 ^	187.00	11	0.44-4.40
1 ½	198 807 640 ^	196.00	198 807 648 ^	274.00	20	1.30-13.0
1 ½	198 807 641 ^	196.00	198 807 649 ^	274.00	21	2.60-26.0
2	198 807 642 ^	298.00	198 807 650 ^	422.00	30	4.40-44.0
2	198 807 643 ^	298.00	198 807 651 ^	422.00	31	6.60-66.0
2 ½	198 807 644 ^	489.00	198 807 652 ^	690.00	40	8.80-88.0
2 ½	198 807 645 ^	489.00	198 807 653 ^	690.00	41	13.2-132.0

^ = 40% Restock Charge
* = Non-Cancelable/Non-Returnable

Rotameters

Type 807 Rotameter - Polysulphone Complete Assembly PVC Socket Ends, EPDM Seals, Short Tube C



Size [inch]	Standard Float Part No.	USD	Magnetic Float Part No.	USD	SK	Flow Range [gal/min]
3/8	198 807 550 ^	89.00	198 807 576 ^	126.00	50	0.01-0.11
3/8	198 807 551 ^	89.00	198 807 577 ^	126.00	51	0.02-0.22
3/8	198 807 552 ^	89.00	198 807 578 ^	126.00	52	0.04-0.44
1/2	198 807 553 ^	91.00	198 807 579 ^	139.00	60	0.03-0.33
1/2	198 807 554 ^	91.00	198 807 580 ^	139.00	61	0.06-0.66
1/2	198 807 555 ^	91.00	198 807 581 ^	139.00	62	0.08-0.88
1	198 807 556 ^	107.00	198 807 582 ^	179.00	70	0.06-0.66
1	198 807 557 ^	107.00	198 807 583 ^	179.00	71	0.13-1.32
1	198 807 558 ^	107.00	198 807 584 ^	179.00	72	0.22-2.20
1	198 807 559 ^	107.00	198 807 585 ^	179.00	73	0.44-4.40

^ = 40% Restock Charge

* = Non-Cancelable/Non-Returnable

+GF+

Rotameters

Type 807 Rotameter - Polysulphone Complete Assembly PVC Socket Ends, EPDM Seals, Standard Tube C



Size [inch]	Standard Float Part No.	USD	Magnetic Float Part No.	USD	SK	Flow Range [gal/min]
1	198 807 560 ^	143.00	198 807 568 ^	195.00	10	0.22-2.20
1	198 807 561 ^	143.00	198 807 569 ^	195.00	11	0.44-4.40
1 ½	198 807 562 ^	198.00	198 807 570 ^	286.00	20	1.30-13.0
1 ½	198 807 563 ^	198.00	198 807 571 ^	286.00	21	2.60-26.0
2	198 807 564 ^	305.00	198 807 572 ^	478.00	30	4.40-44.0
2	198 807 565 ^	305.00	198 807 573 ^	478.00	31	6.60-66.0
2 ½	198 807 566 ^	480.00	198 807 574 ^	707.00	40	8.80-88.0
2 ½	198 807 567 ^	480.00	198 807 575 ^	707.00	41	13.2-132.0

Type 807 Rotameter - Polysulphone Complete Assembly PVC Socket Ends, FPM Seals, Short Tube C



Size [inch]	Standard Float Part No.	USD	Magnetic Float Part No.	USD	SK	Flow Range [gal/min]
¾	198 807 602 ^	91.00	198 807 612 ^	128.00	50	0.01-0.11
¾	198 807 603 ^	91.00	198 807 613 ^	128.00	51	0.02-0.22
¾	198 807 604 ^	91.00	198 807 614 ^	128.00	52	0.04-0.44
½	198 807 605 ^	97.00	198 807 615 ^	144.00	60	0.03-0.33
½	198 807 606 ^	97.00	198 807 616 ^	144.00	61	0.06-0.66
½	198 807 607 ^	97.00	198 807 617 ^	144.00	62	0.08-0.88
1	198 807 608 ^	111.00	198 807 618 ^	184.00	70	0.06-0.66
1	198 807 609 ^	111.00	198 807 619 ^	184.00	71	0.13-1.32
1	198 807 610 ^	111.00	198 807 620 ^	184.00	72	0.22-2.20
1	198 807 611 ^	111.00	198 807 621 ^	184.00	73	0.44-4.40

^ = 40% Restock Charge
* = Non-Cancelable/Non-Returnable

Rotameters

Type 807 Rotameter - Polysulphone Complete Assembly PVC Socket Ends, FPM Seals, Standard Tube C



Size [inch]	Standard Float Part No.	USD	Magnetic Float Part No.	USD	SK	Flow Range [gal/min]
1	198 807 586 ^	147.00	198 807 594 ^	200.00	10	0.22-2.20
1	198 807 587 ^	147.00	198 807 595 ^	200.00	11	0.44-4.40
1 ½	198 807 588 ^	210.00	198 807 596 ^	297.00	20	1.30-13.0
1 ½	198 807 589 ^	229.00	198 807 597 ^	297.00	21	2.60-26.0
2	198 807 590 ^	319.00	198 807 598 ^	491.00	30	4.40-44.0
2	198 807 591 ^	319.00	198 807 599 ^	491.00	31	6.60-66.0
2 ½	198 807 592 ^	492.00	198 807 600 ^	753.00	40	8.80-88.0
2 ½	198 807 593 ^	492.00	198 807 601 ^	753.00	41	13.2-132.0

^ = 40% Restock Charge

* = Non-Cancelable/Non-Returnable

+GF+

Rotameters

UPW Rotameter - Type 801 Float in PTFE, Fusion Spigots BCF

C



d [mm]	Part No.	USD	SK	Flow Range [gal/min]	Flow Range [l/h]	D [inch]	L [inch]	L2 [inch]
32	198 801 209 *	304.00	70	0.36-1.0	59-182	2.36	7.91	13.39
32	198 801 210 *	304.00	71	0.4-1.4	79-300	2.36	7.91	13.39

UPW Rotameter - Type 801 Float in PTFE With fusion spigots BCF

C



Type	d [mm]	Scale range [l/h]	Scale range [gal/min]	Taper tube in Polysulfone O-rings in FPM Part No.	USD
SK 73	32	136 - 795	0.6-3.5	198 801 202 *	304.00
SK 20	50	568 - 2273	2.5-10.0	198 801 203 *	534.00
SK 21	50	909 - 4091	4.0-18.0	198 801 204 *	534.00
SK 30	63	1000 - 8142	4.4-36.0	198 801 205 *	717.00
SK 31	63	1000 - 9091	4.4-40.0	198 801 206 *	717.00
SK 40	75	1848 - 11364	8.0-50.0	198 801 207 *	1075.00
SK 41	75	2273 - 16364	10.0-72.0	198 801 208 *	1075.00

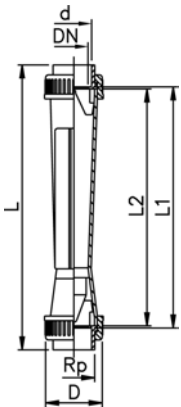

Type	D [inch]	L [inch]	L1 [inch]	L2 [inch]	Rp [inch]
SK 73	2.36	13.31		7.87	1
SK 20	3.27	20.12		13.19	1 ½
SK 21	3.27	20.12		13.19	1 ½
SK 30	4.06	20.63		13.19	2
SK 31	4.06	20.63		13.19	2
SK 40	4.80	19.49		13.19	2 ½
SK 41	4.80	19.49		13.19	2 ½

^ = 40% Restock Charge
* = Non-Cancelable/Non-Returnable

Rotameters

Type 801 Polysulphone UPW Tube Only FPM Seals

C

See end of section for end connector options and pricing

d [mm]	Part No.	USD	Flow Range [gal/min]
32	700 251 574 *	72.00	0.6-3.5
50	700 251 575 *	109.00	2.5-10.0
50	700 251 576 *	109.00	4.0-18.0
63	700 251 577 *	151.00	4.4-35.0
63	700 251 578 *	151.00	4.4-40.0
75	700 251 579 *	269.00	8.0-50.0
75	700 251 580 *	269.00	10.0-72.0

Type 806 Polyamide Tube Only Standard Tube

C

See end of section for end connector options and pricing

Size [inch]	Standard Float Part No.	USD	Magnetic Float Part No.	USD	SK	Flow Range [gal/min]
1	198 806 225 *	118.00	198 806 237 *	164.00	10	0.22-2.20
1	198 806 226 *	118.00	198 806 238 *	164.00	11	0.44-4.40
1 ½	198 806 227 *	160.00	198 806 239 *	233.00	20	1.30-13.0
1 ½	198 806 228 *	160.00	198 806 240 *	233.00	21	2.60-26.0
2	198 806 229 *	253.00	198 806 241 *	370.00	30	4.40-44.0
2	198 806 230 *	253.00	198 806 242 *	370.00	31	6.60-66.0
2 ½	198 806 271	Call	198 806 272	Call	40	8.80-88.0
2 ½	198 806 275	Call	198 806 276	Call	41	13.2-132.0

Type 806 Polysulphone Tube Only Short Tube

C

See end of section for end connector options and pricing

Size [inch]	Standard Float Part No.	USD	Magnetic Float Part No.	USD	SK	Flow Range [gal/min]
⅜	198 806 100 *	80.00	198 806 110 *	117.00	50	0.01-0.11
⅜	198 806 101 *	80.00	198 806 111 *	117.00	51	0.02-0.22
⅜	198 806 102 *	80.00	198 806 112 *	117.00	52	0.04-0.44
½	198 806 103 *	82.00	198 806 113 *	129.00	60	0.03-0.33
½	198 806 104 *	82.00	198 806 114 *	129.00	61	0.06-0.66
½	198 806 105 *	82.00	198 806 115 *	129.00	62	0.08-0.88
1	198 806 106 *	91.00	198 806 116 *	164.00	70	0.06-0.66
1	198 806 107 *	91.00	198 806 117 *	164.00	71	0.13-1.32
1	198 806 108 *	91.00	198 806 118 *	164.00	72	0.22-2.20
1	198 806 109 *	91.00	198 806 119 *	164.00	73	0.44-4.40

^ = 40% Restock Charge

* = Non-Cancelable/Non-Returnable

Rotameters

Type 806 Polysulphone Tube Only Standard Tube

C

See end of section for end connector options and pricing

Size [inch]	Standard Float Part No.	USD	Magnetic Float Part No.	USD	SK	Flow Range [gal/min]
1	198 806 231 *	125.00	198 806 243 *	176.00	10	0.22-2.20
1	198 806 232 *	125.00	198 806 244 *	176.00	11	0.44-4.40
1 ½	198 806 233 *	171.00	198 806 245 *	256.00	20	1.30-13.0
1 ½	198 806 234 *	171.00	198 806 246 *	256.00	21	2.60-26.0
2	198 806 235 *	268.00	198 806 247 *	438.00	30	4.40-44.0
2	198 806 236 *	268.00	198 806 248 *	438.00	31	6.60-66.0
2 ½	198 806 273	Call	198 806 274	Call	40	8.80-88.0
2 ½	198 806 277	Call	198 806 278	Call	41	13.2-132.0

^ = 40% Restock Charge
* = Non-Cancelable/Non-Returnable

Rotameters

Rotameter Component Parts

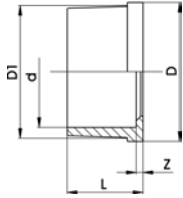

Union Ends, PVC IPS Socket

B

Model:

- Solvent cement socket ASTM

d [inch]	PN	Part No.	USD	z [inch]	D [inch]	D1 [inch]	L [inch]	
3/8	240	721 602 005	1.00	0.12	0.94	0.87	0.87	
1/2	240	721 602 006	1.00	0.12	1.18	1.10	0.98	
1	240	721 602 008	2.00	0.12	1.77	1.65	1.26	
1 1/2	240	721 602 010	4.00	0.12	2.48	2.32	1.50	
2	240	721 602 011	6.00	0.12	3.07	2.91	1.61	

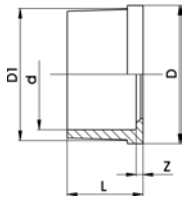

Union Ends, PVC Metric Socket

C

Model:

- Solvent cement socket metric
- Suitable for unions, tank connectors and diaphragm valves Type 314

* for Adaptor Unions 21 53 02, 21 53 07, 21 55 02, 21 55 07 old version

d [mm]	PN	Part No.	USD	z [inch]	D [inch]	D1 [inch]	L [inch]	
16	240	721 600 105	1.00	0.12	0.94	0.87	0.67	
20	240	721 600 106	1.00	0.12	1.18	1.10	0.75	
32	240	721 600 108	2.00	0.12	1.77	1.65	0.98	
50	240	721 600 110	4.00	0.12	2.48	2.32	1.34	
63	240	721 600 111	6.00	0.12	3.07	2.91	1.61	
*75	150	721 600 112	12.00	0.12	3.82	3.54	1.85	

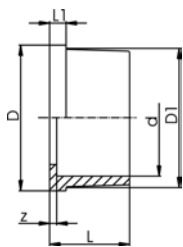

Union Ends, PP Socket

C

Model:

- Material: PP-H
- With fusion sockets metric
- Suitable for unions, diaphragm valves Type 314, tank adaptors and Vortex sensors

d [mm]	PN	Part No.	USD	D [inch]	D1 [inch]	L [inch]	L1 [inch]	z [inch]	
16	150	727 600 105	3.00	0.94	0.87	0.71	0.16	0.12	
20	150	727 600 106	3.20	1.18	1.10	0.75	0.20	0.12	
32	150	727 600 108	4.10	1.77	1.65	0.91	0.24	0.12	
50	150	727 600 110	6.40	2.48	2.32	1.10	0.28	0.12	
63	150	727 600 111	7.50	3.11	2.91	1.26	0.31	0.12	
75	150	727 600 112	30.00	3.98	3.58	1.42	0.39	0.12	

^ = 40% Restock Charge

* = Non-Cancelable/Non-Returnable

Rotameters

Union End, PVDF Standard Socket

C

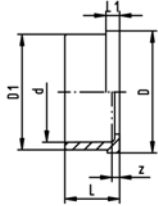

Model:

- Material: PVDF
- Suitable for SYGEF® Standard Union Socket Fusion
- Suitable for Diaphragm Valve Type 314
- Suitable for Vortex Sensor

d [mm]	PN	Part No.	USD	D [inch]	D1 [inch]	L [inch]	L1 [inch]	z [inch]
16	240	735 600 105	10.80	0.94	0.87	0.71	0.16	0.20
20	240	735 600 106	11.30	1.18	1.10	0.75	0.20	0.20
32	240	735 600 108	15.90	1.77	1.65	0.91	0.24	0.20
50	240	735 600 110	24.40	2.48	2.32	1.10	0.28	0.20
63	240	735 600 111	32.90	3.07	2.91	1.26	0.28	0.20

Union Ends, PVC Threaded

B

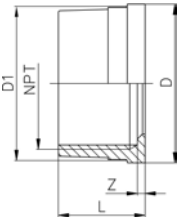

Model:

- Taper female thread NPT (ASTM)

NPT [inch]	PN	Part No.	USD	z [inch]	D [inch]	D1 [inch]	L [inch]
½	150	721 602 656	4.00	0.08	1.18	1.10	0.75
1	150	721 602 658	6.00	0.12	1.77	1.65	0.98
1 ½	150	721 602 660	13.00	0.43	2.48	2.32	1.34
2	150	721 602 661	13.00	0.67	3.07	2.91	1.61

End Connectors

PVC Socket End Connectors

C

d [mm]	Size [inch]	PVC (inch) Part No.	USD
75	2 ½	700 259 430	23.00

End Connectors

PVDF Socket End Connectors

C

d [mm]	Size [inch]	PVDF (mm) Part No.	USD
75	2 ½	735 600 112	33.00

^ = 40% Restock Charge
* = Non-Cancelable/Non-Returnable

Rotameters

End Connectors

PP Threaded End Connectors

C

d [mm]	Size [inch]	PP (FNPT) Part No.	USD
20	½	198 203 603	16.00
32	1	198 203 604	18.00
50	1 ½	198 203 606	21.00
63	2	198 203 607	24.00

End Connectors

PVDF Threaded End Connectors

C

d [mm]	Size [inch]	PVDF (FNPT) Part No.	USD
20	½	198 203 611	20.00
32	1	198 203 612	30.00
50	1 ½	198 203 614	48.00
63	2	198 203 615	59.00



Union Nut, PVC

C

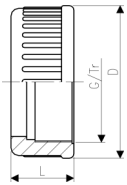

d [mm]	PN	Part No.	USD	D [inch]	L [inch]	G [inch]	Tr
16	240	721 690 005	2.00	1.38	0.83	¾	
20	240	721 690 006	2.00	1.69	0.91	1	
32	240	721 690 008	3.00	2.28	1.02	1 ½	
50	240	721 690 010	6.00	3.27	1.34	2 ¼	
63	240	721 690 011	8.00	3.94	1.50	2 ¾	



Union Nut, PP

C

Model:

- PP glass-fibre reinforced

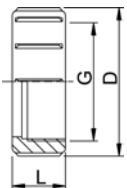

Socket Fusion d [mm]	Butt Fusion d [mm]	PN	G (R/Rp BS Thread) [inch]	Part No.	USD	D [inch]	L [inch]
16	16	150	¾	727 690 405	11.30	1.38	0.83
20	20	150	1	727 690 406	12.80	1.89	0.94
32	32	150	1 ½	727 690 408	15.80	2.56	1.10
50	50	150	2 ¼	727 690 410	33.00	3.58	1.38
63	63	150	2 ¾	727 690 411	52.00	4.37	1.54

^ = 40% Restock Charge

* = Non-Cancelable/Non-Returnable

+GF+

Rotameters

Union Nut, PN 16, PVDF Standard

C

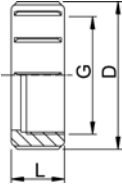

Model:

- Material: PVDF
- d75, d90 and d110 with buttress shaped thread

Note:

- For the dimensions d75-110 please see instructions for the installation

Socket Fusion d [mm]	Butt Fusion d [mm]	PN	Part No.	USD	D [inch]	G (R/Rp BS Thread) [inch]	L [inch]
16	16	240	735 690 405	14.70	1.38	3/4	0.83
20	20	240	735 690 406	19.20	1.69	1	0.87
32	32	240	735 690 408	31.50	2.36	1 1/2	1.02
50	50	240	735 690 410	65.00	3.23	2 1/4	1.30
63	63	240	735 690 411	101.00	3.94	2 3/4	1.38

Rotameter Tubes - Special Scales NaOH at 30%

C



Size [inch]	Part No.	USD	SK	Flow Range [gal/min]
1	198 801 477	20.00	10	0.066-1.05
1	198 801 478	20.00	11	0.22-2.65
1 1/2	198 801 479	20.00	20	0.88-8.80
1 1/2	198 801 480	20.00	21	2.20-19.85
2	198 801 481	20.00	30	2.20-33.0
2	198 801 482	20.00	31	3.52-48.0
2 1/2	198 801 483	20.00	40	6.16-66.0
2 1/2	198 801 484	20.00	41	8.8-88.0

Rotameter Tubes - Special Scales NaOH at 50%

C



Size [inch]	Part No.	USD	SK	Flow Range [gal/min]
1	198 801 485	20.00	10	0.008-0.26
1	198 801 486	20.00	11	0.04-0.84
1 1/2	198 801 487	20.00	20	0.22-4.4
1 1/2	198 801 488	20.00	21	0.44-11.0
2	198 801 489	20.00	30	0.44-21.0
2	198 801 490	20.00	31	1.32-30.8
2 1/2	198 801 491	20.00	40	2.20-48.4
2 1/2	198 801 492	20.00	41	4.40-61.6

^ = 40% Restock Charge
* = Non-Cancelable/Non-Returnable

Rotameters



Rotameter Tubes - Special Scales Air 14.7PSI (1 bar)

C

Size [inch]	Part No.	USD	SK	SCFM Range
1	198 801 356	20.00	10	1.2-10.0
1	198 801 357	20.00	11	2.5-18.8
1 ½	198 801 358	20.00	20	7.0-52.9
1 ½	198 801 359	20.00	21	12.5-104
2	198 801 360	20.00	30	20-162.5
2	198 801 361	20.00	31	30-245
2 ½	198 801 362	20.00	40	38-405
2 ½	198 801 363	20.00	41	60-512



Rotameter Tubes - Special Scales HCl at 30%-33%

C

Size [inch]	Part No.	USD	SK	Flow Range [gal/min]
1	198 801 469	20.00	10	0.22-1.98
1	198 801 470	20.00	11	.66-3.95
1 ½	198 801 471	20.00	20	2.2-11.0
1 ½	198 801 472	20.00	21	3.1-22.0
2	198 801 473	20.00	30	3.1-37.5
2	198 801 474	20.00	31	4.4-52.9
2 ½	198 801 475	20.00	40	8.8-88.0
2 ½	198 801 476	20.00	41	15.8-110.0

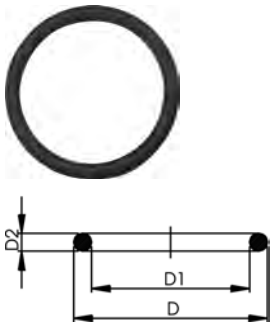

O-Ring

C

Model:

- For unions and adaptor unions
- Hardness approx. 65° Shore
- EPDM minimum temperature -40°F
- FPM minimum temperature -15°F

d [mm]	EPDM Part No.	USD	FPM Part No.	USD	D [inch]	D1 [inch]	D2 [inch]
16	748 410 005	1.00	749 410 005	2.00	0.83	0.63	0.12
20	748 410 006	2.40	749 410 006	4.60	1.06	0.79	0.16
32	748 410 008	2.00	749 410 008	5.00	1.57	1.30	0.16
50	748 410 010	2.00	749 410 010	8.00	2.28	1.85	0.20
63	748 410 011	2.00	749 410 011	9.00	2.76	2.36	0.20
75	748 410 014	6.30	749 410 014	15.30	3.66	3.23	

^ = 40% Restock Charge

* = Non-Cancelable/Non-Returnable

+GF+

Rotameters

Special scale for standard version Water l/h

C

Type	Scale range [l/h]	Part No.	USD	
SK 10 / 100	50 - 500	198 801 955	7.00	
SK 11 / 110	100 - 1000	198 801 956	7.00	
SK 20 / 200	300 - 3000	198 801 957	7.00	
SK 21 / 210	600 - 6000	198 801 958	7.00	
SK 30 / 300	1000 - 10000	198 801 959	7.00	
SK 31 / 310	1500 - 15000	198 801 960	7.00	
SK 40 / 400	2000 - 20000	198 801 876	7.00	
SK 41 / 410	3000 - 30000	198 801 877	7.00	

Special scale for standard version Water in %

C

Type	measure- ment range [%]	Part No.	USD	
SK 10 / 110	10 - 100	198 802 076	7.00	
SK 11 / 110	10 - 100	198 802 077	7.00	
SK 20 / 200	10 - 100	198 802 078	7.00	
SK 21 / 210	10 - 100	198 802 079	7.00	
SK 30 / 300	10 - 100	198 802 080	7.00	
SK 31 / 310	10 - 100	198 802 081	7.00	
SK 40 / 410	10 - 100	198 802 082	7.00	
SK 41 / 410	10 - 100	198 802 083	7.00	

Special scale for standard version m3/h

C

Type	Scale range [m³/h]	Part No.	USD	
SK 10 / 100	0,05 - 0,5	198 801 937	7.00	
SK 11 / 110	0,1 - 1	198 801 938	7.00	
SK 20 / 200	0,3 - 3	198 801 939	7.00	
SK 21 / 210	0,6 - 6	198 801 940	7.00	
SK 30 / 300	1 - 10	198 801 941	7.00	
SK 31 / 310	1,5 - 15	198 801 942	7.00	
SK 40 / 400	2 - 20	198 801 318	7.00	
SK 41 / 410	3 - 30	198 801 319	7.00	

^ = 40% Restock Charge
* = Non-Cancelable/Non-Returnable

Rotameters

Special scale for standard version GPM

C

Type	Scale range [gal/min]	Part No.	USD
SK 10 / 100	0,22 - 2,2	198 801 949	7.00
SK 11 / 110	0,44 - 4,4	198 801 950	7.00
SK 20 / 200	1,32 - 13,2	198 801 951	7.00
SK 21 / 210	2,64 - 26,4	198 801 952	7.00
SK 30 / 300	4,40 - 44,02	198 801 953	7.00
SK 31 / 310	6,60 - 66,04	198 801 954	7.00
SK 40 / 400	8,80 - 88	198 801 320	7.00
SK 41 / 410	13,20 - 132	198 801 321	7.00

Special scale for standard version Air: 14.7 psi/0bar - Nm³/h

C

Type	Scale range [m ³ /h]	Part No.	USD
SK 10 / 100	2,1 - 16	198 801 284	20.00
SK 11 / 110	4,2 - 32	198 801 285	20.00
SK 18 / 180	10 - 70	198 803 821	Call
SK 20 / 200	12,1 - 90	198 801 286	20.00
SK 21 / 210	21,1 - 177	198 801 287	20.00
SK 29 / 290	22 - 190	198 803 823	Call
SK 30 / 300	34,2 - 276	198 801 288	20.00
SK 31 / 310	49,6 - 414	198 801 289	20.00
SK 40 / 400	60 - 580	198 801 322	20.00
SK 41 / 410	100 - 860	198 801 323	20.00

Special scale for standard version HCI 30-33% l/h

C

Type	Scale range [l/h]	Part No.	USD
SK 10 / 100	50 - 450	198 801 290	20.00
SK 11 / 110	150 - 900	198 801 291	20.00
SK 18 / 180	200 - 1900	198 803 825	Call
SK 20 / 200	500 - 2500	198 801 292	20.00
SK 21 / 210	700 - 5000	198 801 293	20.00
SK 29 / 290	800 - 5600	198 803 827	Call
SK 30 / 300	700 - 8500	198 801 294	20.00
SK 31 / 310	1000 - 12000	198 801 295	20.00
SK 40 / 400	2000 - 18000	198 801 324	20.00
SK 41 / 410	3600 - 25000	198 801 325	20.00

^ = 40% Restock Charge

* = Non-Cancelable/Non-Returnable

+GF+

Rotameters

Special scale for standard version NaOH 30% l/h

C

Type	Scale range [l/h]	Part No.	USD	
SK 10 / 100	15 - 240	198 801 296	20.00	
SK 11 / 110	50 - 600	198 801 297	20.00	
SK 18 / 180	100 - 1400	198 803 829	Call	
SK 20 / 200	200 - 2000	198 801 298	20.00	
SK 21 / 210	500 - 4500	198 801 299	20.00	
SK 29 / 290	400 - 4600	198 803 831	Call	
SK 30 / 300	500 - 7500	198 801 300	20.00	
SK 31 / 310	800 - 11000	198 801 301	20.00	
SK 40 / 400	1400 - 15000	198 801 326	20.00	
SK 41 / 410	2000 - 20000	198 801 327	20.00	

Special scale for standard version NaOH 50% l/h

C

Type	Scale range [l/h]	Part No.	USD	
SK 10 / 100	2 - 60	198 801 302	20.00	
SK 11 / 110	10 - 190	198 801 303	20.00	
SK 18 / 180	20 - 600	198 803 833	Call	
SK 20 / 200	50 - 1000	198 801 304	20.00	
SK 21 / 210	100 - 2500	198 801 305	20.00	
SK 29 / 290	200 - 3400	198 803 835	Call	
SK 30 / 300	100 - 4750	198 801 306	20.00	
SK 31 / 310	300 - 7000	198 801 307	20.00	
SK 40 / 400	500 - 11000	198 801 328	20.00	
SK 41 / 410	1000 - 14000	198 801 329	20.00	

Special scale for short version Water

C

Type	Scale range [l/h]	Part No.	USD	
SK 50 / 500	2,5 - 25	198 801 386	7.00	
SK 51 / 510	5 - 50	198 801 387	7.00	
SK 52 / 520	10 - 100	198 801 388	7.00	
SK 60 / 600	8 - 80	198 801 389	7.00	
SK 61 / 610	15 - 150	198 801 390	7.00	
SK 62 / 620	20 - 200	198 801 391	7.00	
SK 70 / 700	15 - 150	198 801 392	7.00	
SK 71 / 710	30 - 300	198 801 393	7.00	
SK 72 / 720	50 - 500	198 801 394	7.00	
SK 73 / 730	100 - 1000	198 801 395	7.00	

^ = 40% Restock Charge
* = Non-Cancelable/Non-Returnable

Rotameters

Special scale for short version GPM

C

Type	Scale range [gal/min]	Part No.	USD
SK 50 / 500	0,01 - 0,11	198 801 961	7.00
SK 51 / 510	0,02 - 0,22	198 801 962	7.00
SK 52 / 520	0,04 - 0,44	198 801 963	7.00
SK 60 / 600	0,03 - 0,35	198 801 964	7.00
SK 61 / 610	0,06 - 0,66	198 801 965	7.00
SK 62 / 620	0,08 - 0,88	198 801 966	7.00
SK 70 / 700	0,06 - 0,66	198 801 967	7.00
SK 71 / 710	0,13 - 1,32	198 801 968	7.00
SK 72 / 720	0,22 - 2,20	198 801 969	7.00
SK 73 / 730	0,44 - 4,40	198 801 970	7.00

Spare part for variable area flow meter SK10-SK41/SK100-SK410 Standard version float PVDF Without magnet

C

Type	d [mm]	Part No.	USD
SK 10 / 11 / 12	32	198 801 977	116.00
SK 19 / 20 / 21	50	198 801 978	134.00
SK 30 / 31	63	198 801 979	184.00
SK 40	75	198 801 987	254.00
SK 41	75	198 801 344	254.00

Spare part for variable area flow meter SK10-SK41/SK100-SK410 Standard Version Magnetic Float PVDF

C

Type	d [mm]	Part No.	USD
SK 100 / 110 / 120	32	198 801 980	122.00
SK 190 / 200 / 210	50	198 801 981	159.00
SK 300 / 310	63	198 801 982	272.00
SK 400	75	198 801 988	326.00
SK 410	75	198 801 345	326.00

Spare Part for Variable Area Flow Meter SK50-SK73/SK500-SK730 Short version float PVDF Without magnet

C

Type	d [mm]	Part No.	USD
SK 50 / 51 / 52	16	198 806 219	66.00
SK 60 / 61 / 62	20	198 806 220	71.00
SK 70 / 71 / 72 / 73	32	198 806 221	78.00

^ = 40% Restock Charge

* = Non-Cancelable/Non-Returnable

+GF+

Rotameters

Spare Part for Variable Area Flow Meter SK50-SK73/SK500-SK730 Short Version Magnetic Float PVDF

C

Type	d [mm]	Part No.	USD
SK 500 / 510 / 520	16	198 806 222	85.00
SK 600 / 610 / 620	20	198 806 223	96.00
SK 700 / 710 / 720 / 730	32	198 806 224	116.00



Accessories Limit switch maximum or minimum for standard version

C

Type	GK 01 Part No.	USD
SK100-120 / 190-210 / 300-410	198 801 936	50.00



Accessories Limit switch, short version

C

Type	Maximum Part No.	USD	Minimum Part No.	USD
SK500-730 GK 03	198 801 878	50.00	-	
SK500-730 GK 04	-		198 801 879	50.00



Accessories 4-20 mA sensor Type GK 05

C

- Kit GK 05:
- 1 x sensor 4-20 mA
- 1 x float PVDF with magnet (monostable)
- Basic unit is standard version (without magnet)

Type	d [mm]		Part No.	USD
GK 05	32	SK 10 / 11	199 190 334	381.00
GK 05	50	SK 20 / 21	199 190 335	383.00
GK 05	63	SK 30 / 31	199 190 336	402.00
GK 05	75	SK 40	199 190 337	471.00
GK 05	75	SK 41	199 190 338	471.00

^ = 40% Restock Charge
* = Non-Cancelable/Non-Returnable

End Connection Options

- A** PVC Threaded
- B** PVC Flanged
- C** PP Socket
- D** PP Threaded
- E** PP Flanged
- F** PVDF Socket
- G** PVDF Threaded
- H** PVDF Flanged

Seal Options

- A** EPDM
- B** FPM

Build your own Rotameter Assembly

Combine to build final part number

Example: A 2" PSU Rotameter with Polypropylene socket end connections, EPDM seals, with a non-magnetic float will have the following part number: **198 806 235 DA**

1) Choose Tube Assembly, 2) Choose Ends, and 3) Choose Seals

Tube Assembly	End Connection	Seal Material
198 806 235	D	A

List Price = \$232 + \$95 + No Charge = \$327

Rotameters Options Price Adders

(C)

End Connections									Seals	
Size Inch	Option A \$	Option B \$	Option C \$	Option D \$	Option E \$	Option F \$	Option G \$	Option H \$	Option A \$	Option B \$
3/8	N/A	N/A	18.00	N/A	N/A	32.00	N/A	N/A	N/C	3.00
1/2	11.00	17.00	18.00	46.00	44.00	36.00	61.00	71.00	N/C	5.00
1	21.00	23.00	55.00	55.00	71.00	57.00	100.00	110.00	N/C	5.00
1½	33.00	35.00	45.00	77.00	109.00	100.00	167.00	179.00	N/C	13.00
2	38.00	44.00	67.00	100.00	147.00	147.00	225.00	248.00	N/C	15.00
2½	N/A	200.00	325.00	N/A	420.00	350.00	N/A	520.00	N/C	23.00